

- NOTES:**
- EXISTING CONCRETE AND BITUMINOUS PAVEMENT SHALL BE REMOVED TO STATION 440+47.26 (P.R. "M").
 - NEW BITUMINOUS PAVEMENT AS SHOWN ON TYPICAL CROSS SECTIONS, SHALL BE BUILT ON SUBGRADE COMPACTED IN ACCORDANCE WITH SECTION 207.02 OF INDOT STANDARD SPECIFICATIONS.
 - THE EXISTING BITUMINOUS SURFACE, FROM 438+25.45 (LINE "M") TO 463+00 (LINE "M"), SHALL BE MILLED OFF UP TO 1 INCH.
 - RESURFACE MILLED AREAS WITH 110#/SYD BITUMINOUS SURFACE 11, MV ON 275#/SYD BITUMINOUS BINDER 8 OR 9, MV
 - DITCH SIDE SLOPE SHALL BE 3:1 UNLESS OTHERWISE SHOWN ON CROSS SECTIONS.

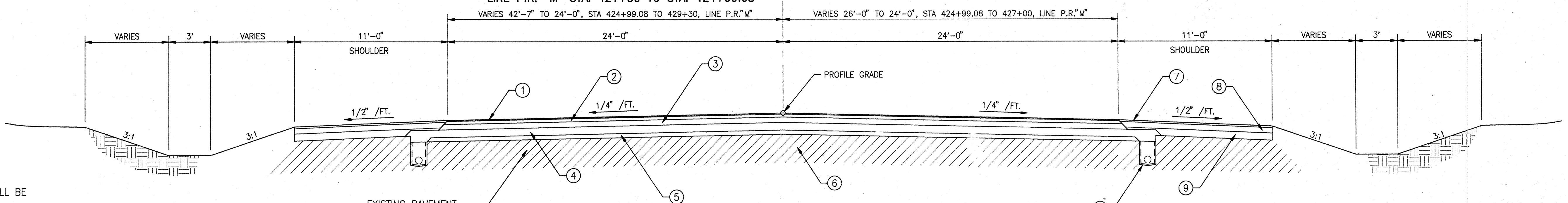

- ① 110#/SYD. BITUMINOUS SURFACE 11, MV
- ② 275#/SYD. BITUMINOUS BINDER 8 OR 9, MV
- ③ 495#/SYD. BITUMINOUS BASE 5, MV
- ④ 700#/SYD. BITUMINOUS BASE 5C, MV
- ⑤ 385#/SYD. BITUMINOUS BASE 5D, MV
- ⑥ COMPACTED SUBGRADE
- ⑦ 165#/SYD. BITUMINOUS SURFACE 11, LV WITH BITUMINOUS CORRUGATIONS
- ⑧ 495#/SYD. BITUMINOUS BASE 5D, LV
- ⑨ 6" COMPACTED AGGREGATE BASE, TYPE O, SIZE NO. 53
- ⑩ CONCRETE CENTER CURB, TYPE "B"
- ⑪ UNDERDRAIN, FOR DETAILS, SEE MISC. STANDARD SHT. "MN"

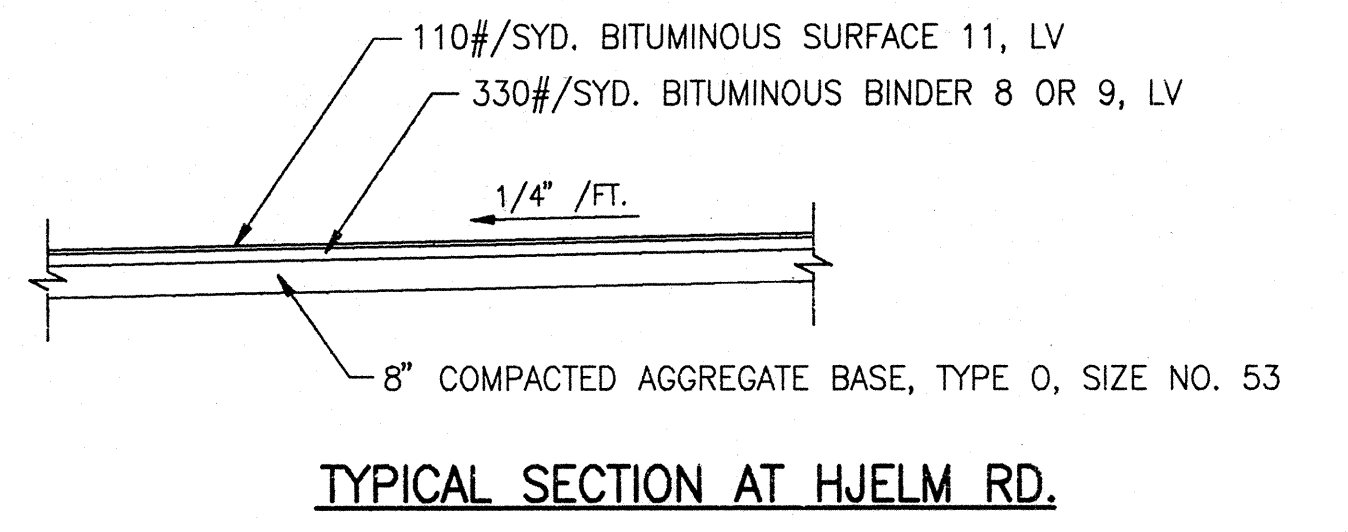
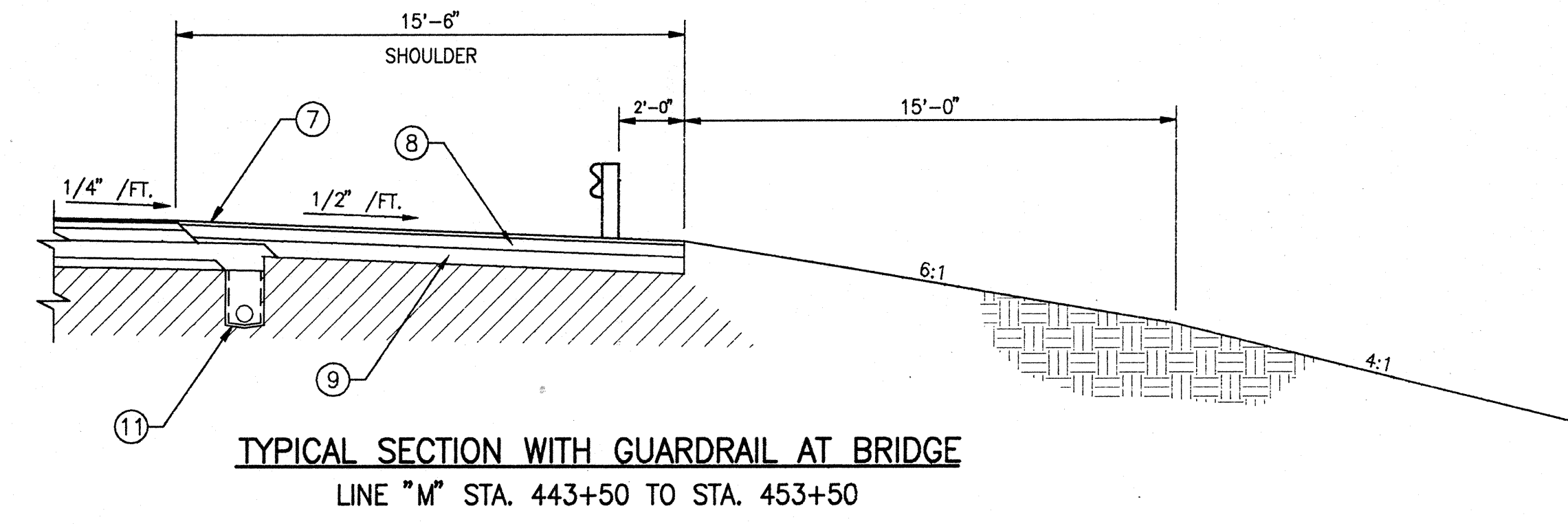
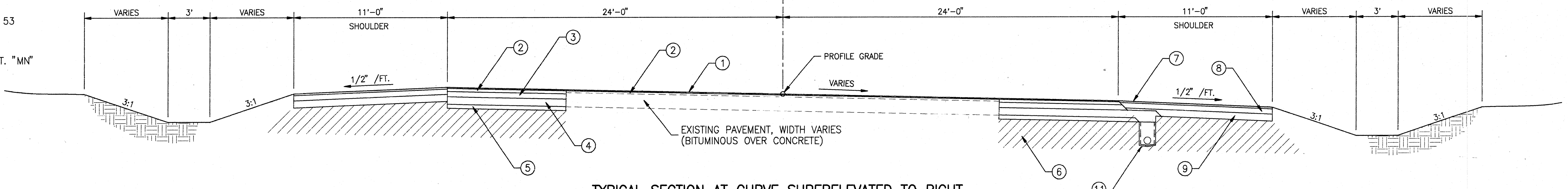
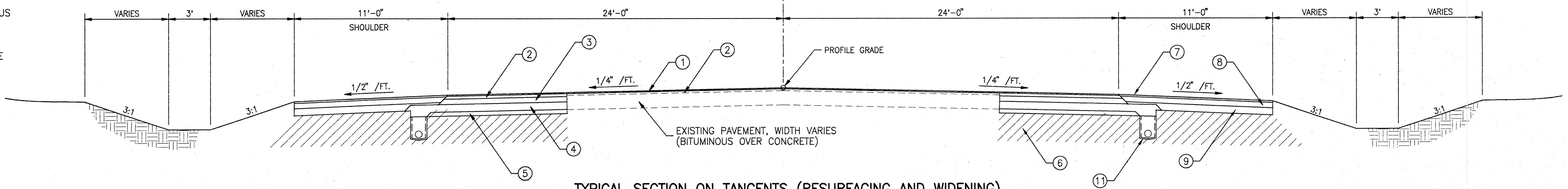

INDIANA DEPARTMENT OF TRANSPORTATION
STATE ROUTE 49, PORTER COUNTY

TYPICAL CROSS SECTION

SCALE: 1/4" = 1'-0"
FOR INFORMATION ONLY

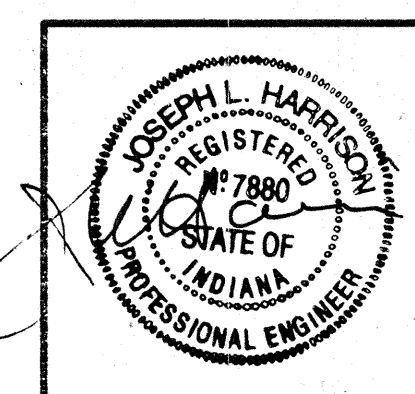

DRAWING ID: P191048 DRAWINGS\TPSEC-BR.DWG PLOT DATE: 07/19/95 16:42

FEDERAL ROAD REGION NO.	STATE	PROJECT NO.	FISCAL YEAR	SHEET NO.	TOTAL SHEETS
5	IND	14-089-4()		3	44

PLAN	DATE
SUBMITTED	
PLOTTED	
ALIGNED CHECKED	
RT. OF WAY CHECKED	
NO.	

PROFILE	DATE
SUBMITTED	
PLOTTED	
GRADES CHECKED	
STRUCTURE NOTATIONS CHKD.	
NO.	

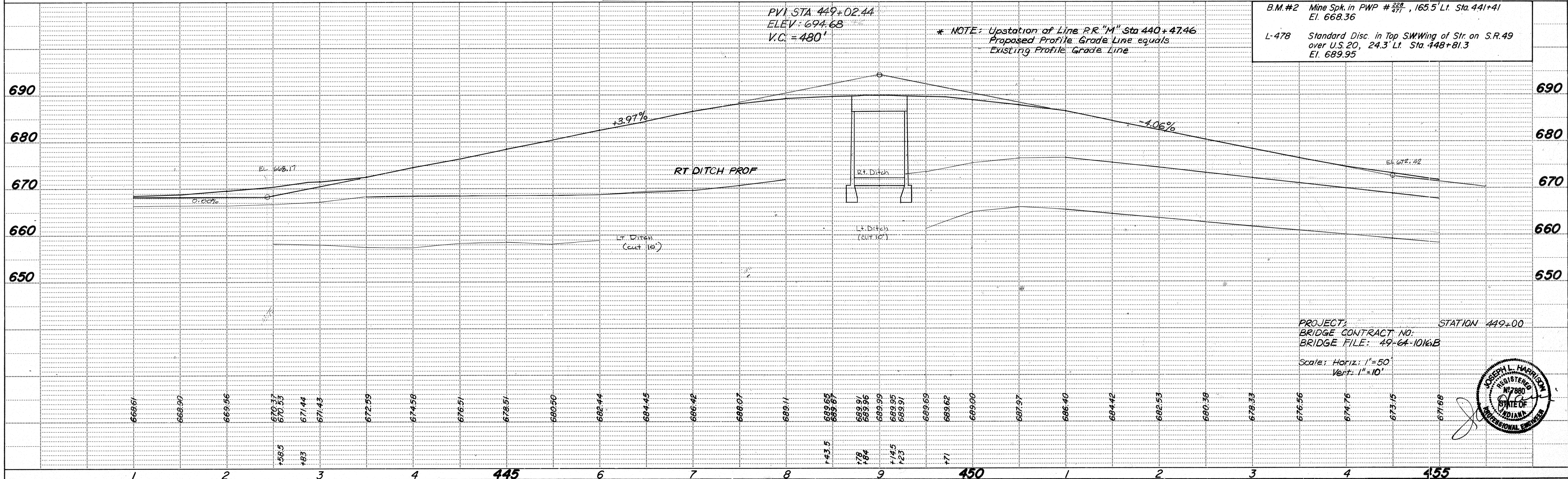
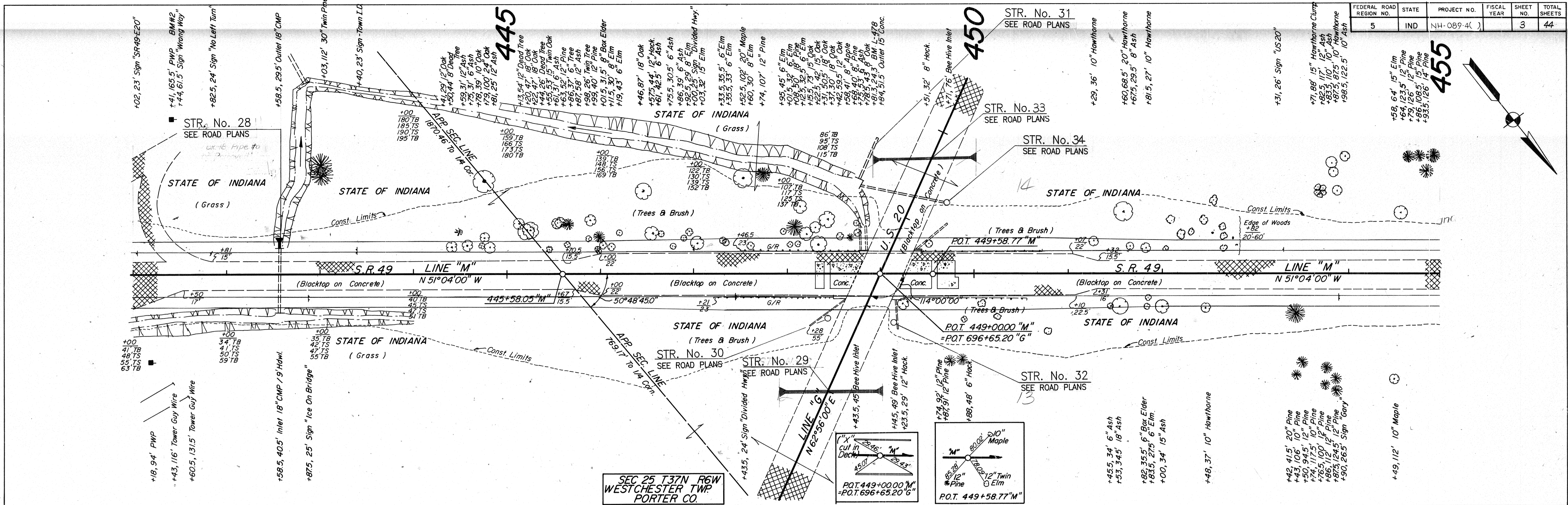

B.M.#2 Mine Spk. in PWP # 228/271, 165.5' Lt. Sta. 441+41 El. 668.36
 L-478 Standard Disc. in Top SWWing of Str. on S.R.49 over U.S. 20, 24.3' Lt. Sta. 448+81.3 El. 689.95

* NOTE: Updatation of Line P.R. "M" Sta 440+47.46 Proposed Profile Grade Line equals Existing Profile Grade Line

PROJECT: BRIDGE CONTRACT NO. 49-6A-1016B
 BRIDGE FILE: 49-6A-1016B
 Scale: Horiz. 1"=50' Vert. 1"=10'
 STATION 449+00

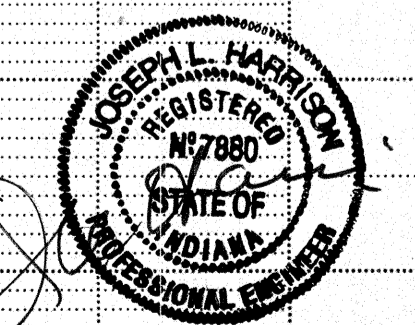

PROJECT NO.	LINE	SHEET NO.	TOTAL SHEETS	FILE
14-089-4()	"M"	3	44	

NOTE: CONTRACTOR SHALL PROVIDE TWO TYPE III-B BARRICADES AND A ROAD CLOSED SIGN W/ TYPE "B" CONST. WARNING LIGHTS FOR EACH RAMP THAT IS CLOSED AT U.S. 20 DURING THAT STAGE. REFER TO STD. SH. 2A.

NOTE: FOR CONST. SIGNS & SPACING FOR EAST BOUND U.S. 20, REFER TO WEST BOUND SIGNING.

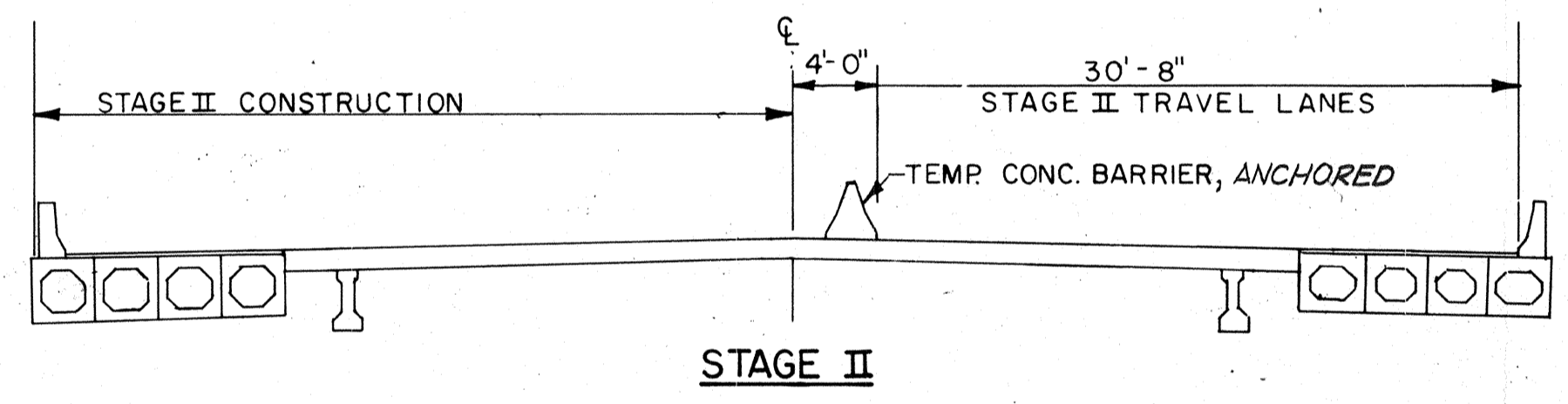
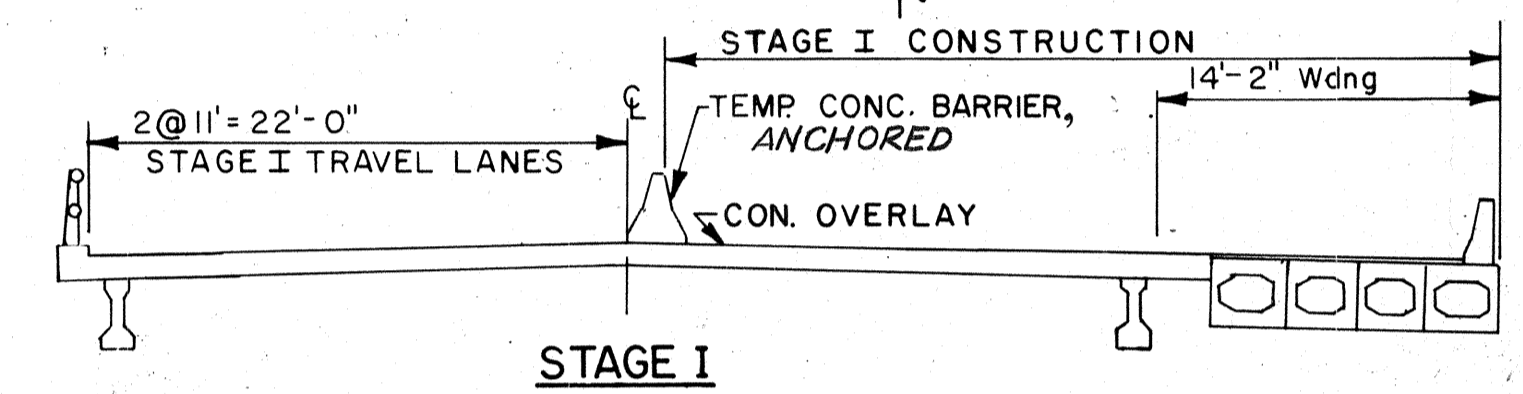
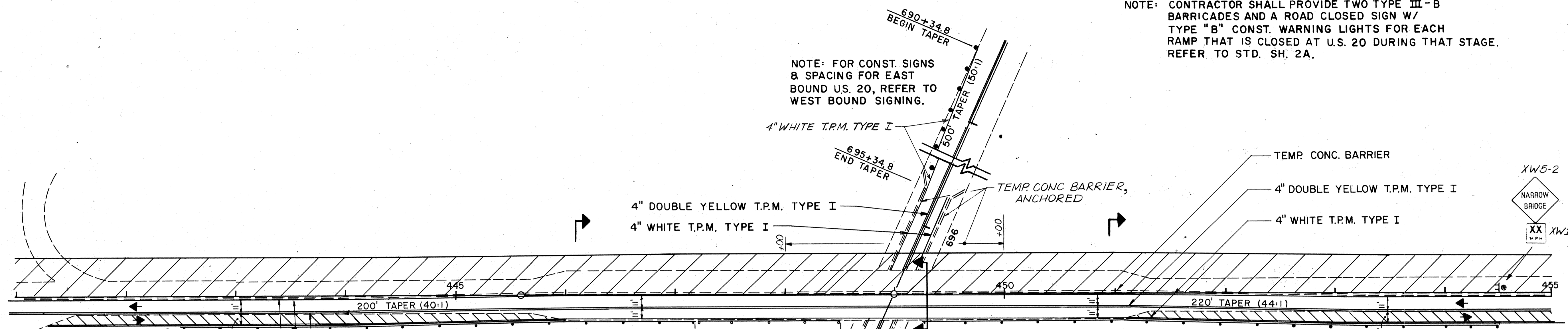

VIEW A-A
SCALE: 1/8" = 1'

- LEGEND OF CONSTRUCTION SIGNS:
- XW1-6 ARROW
 - XW4-2(L) LANE ENDS, MERGE LEFT (SYMBOL)
 - XW2-2(R) LANE ENDS, MERGE RIGHT (SYMBOL)
 - XW5-2 NARROW BRIDGE
 - XW6-3 2 WAY TRAFFIC (SYMBOL)
 - XW9-1(L) RIGHT LANE ENDS
 - XW9-1(R) LEFT LANE ENDS
 - XW9-1-A(L) LEFT LANE ENDS (SYMBOL)
 - XW9-1-A(R) RIGHT LANE ENDS (SYMBOL)
 - XW9-2(L) LANE ENDS, MERGE LEFT
 - XW9-2(R) LANE ENDS, MERGE RIGHT
 - XW20-1 ROAD CONSTRUCTION AHEAD
 - XG20-2 END CONSTRUCTION

- LEGEND
- PAVEMENT TO BE BUILT DURING STAGE I OF CONSTRUCTION
 - TEMPORARY PAVEMENT DURING STAGE I
 - CONSTRUCTION SIGN
 - CONSTRUCTION WARNING LIGHT, TYPE A STD DRUM, SPACING: 100' TANGENT, 40' TAPER
 - TYPE III-B
 - ARROW PANEL
 - TEMP. CONC. BARRIER
 - TYPE "C" CONST. WARN. LIGHT & DELINEATORS

NOTE: MAINTENANCE OF TRAFFIC WORK INCLUDED IN THIS CONTRACT EXTENDS FROM STA. 448+00 TO 450+00 ON S.R.49 AND ON U.S.20 ONLY. ALL OTHER WORK SHOWN IS FOR CONTRACTOR'S INFORMATION ONLY.

PROJECT:
BRIDGE CONTRACT NO: R-22229
BRIDGE FILE: 49-6A-1016B

DETAILS
MAINTENANCE OF TRAFFIC
STATE ROAD 49
SCALE: 1" = 50'



PN = 4067 ELEV = 4452
 DATE 9/13/55 SEC = 1.0946

SEC. 25-T37N-R6W
 WESTCHESTER TWP.
 PORTER COUNTY

PRESENT STRUCTURE
 The present Structure built by Ind. State Highway Commission in 1931 as Road Project 180 1-Span 52'-6 1/2" R.C. Girder Bridge. Bridge was reconstructed in 1971 as Prestressed Conc. Girder Bridge, File No. 49-64-1015A.

UTILITY OWNERS
 Electric Power Line:
 Northern Indiana Public Service Co. Ind.

- Notes**
1. See Roadway Plans for Approach Structures, Bench Markers and additional details.
 2. See Special Provisions for Boring Logs.

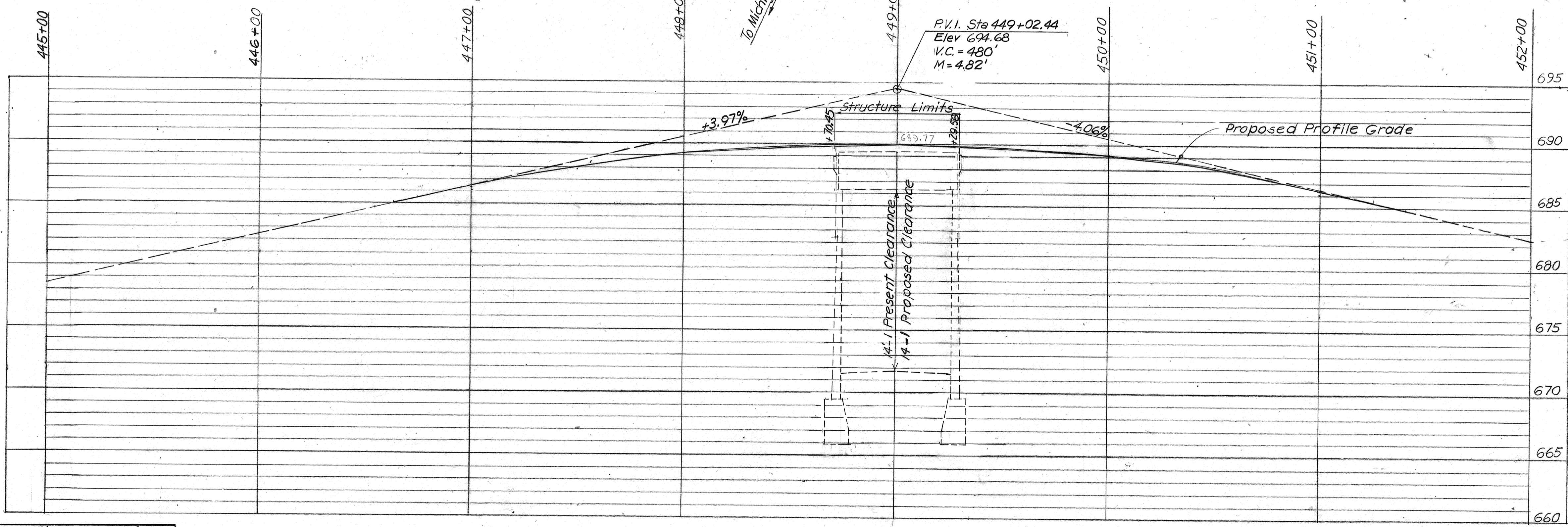
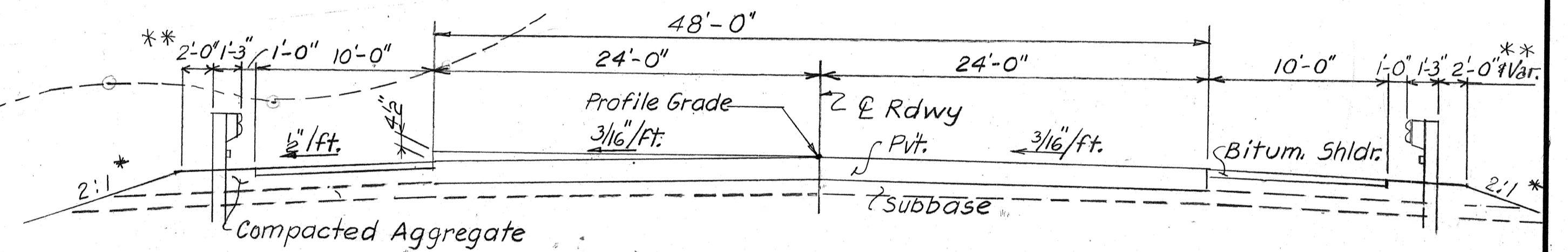
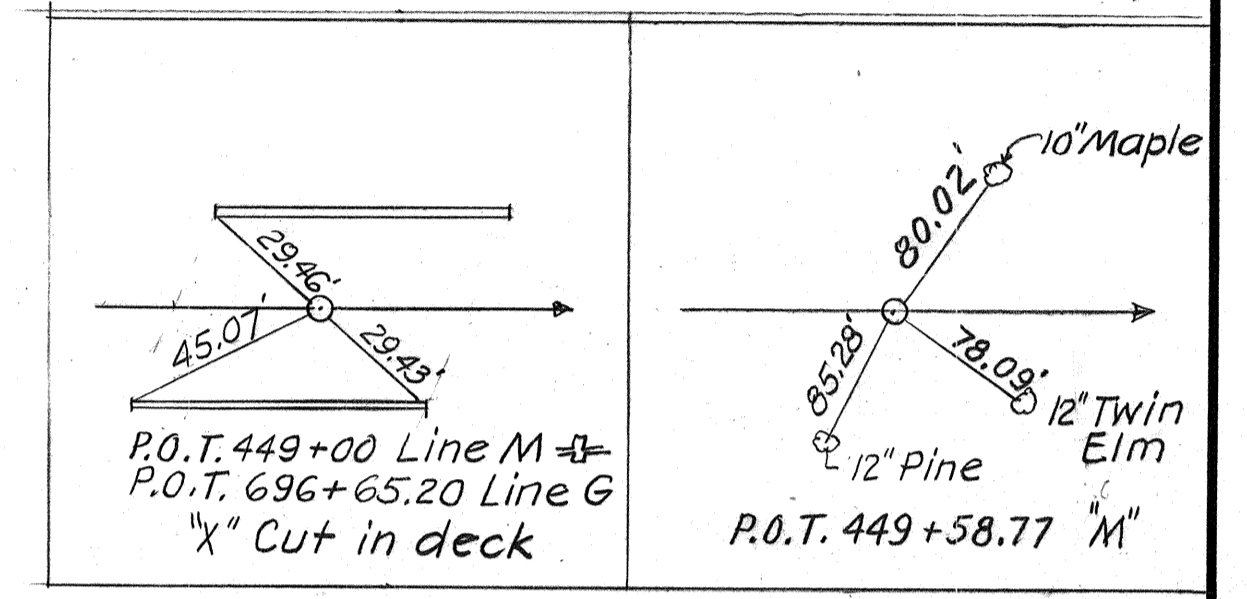
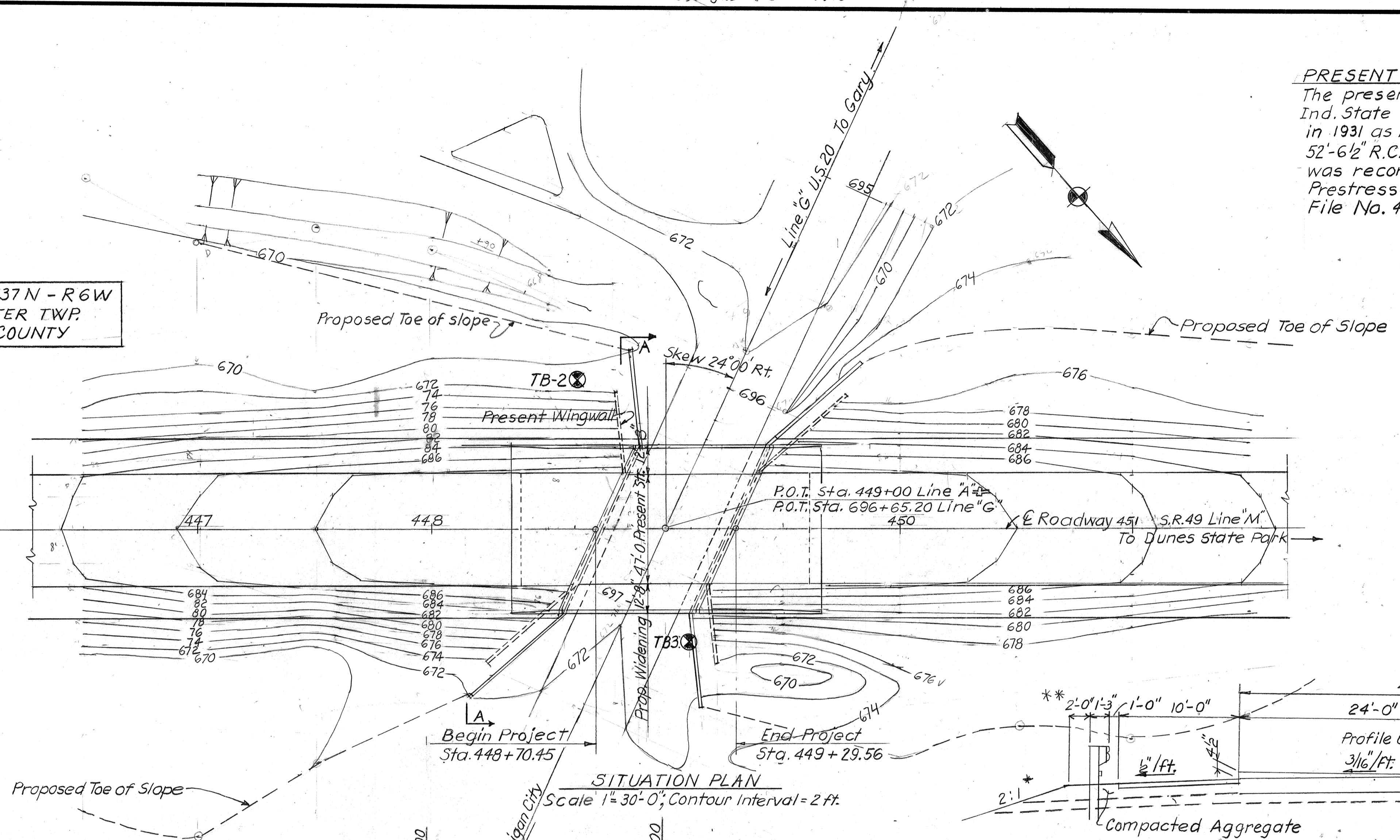

SECTION A-A

Note *: Transition normal Roadway slope within 50.0ft. to 2:1 slope at the end of wingwalls.
 ** Shoulder width at bridge site.

PROFILE ON E ROADWAY
 Scales: Horiz. 1" = 30'-0" Vert. 1" = 5'-0"

Note: Field Notes Book #1

LAYOUT
INDIANA DEPARTMENT OF TRANSPORTATION
 PORTER COUNTY

SCALE: - AS NOTED DATE: 1992
 SENIOR DESIGNER
 DRAWING: S1 OF 8 SHEET: 5 OF 44
 PROJECT: NH-089-4() STATION: 449+00
 BRIDGE CONTRACT NO. R-22229
 BRIDGE FILE: 49-64-1016B

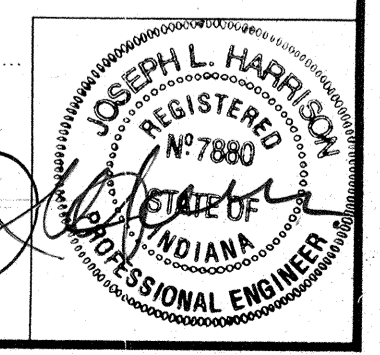

DESIGNED: JLV C.K'D. B.S.
 DRAWN: JLV C.K'D. B.S.
 TRACED: C.K'D.

SF-22317

See Special Prov
for Survey Log

GENERAL NOTES
 Where new work is to be fitted to old work, the Contractor shall check all dimensions and conditions in the field and report any errors or discrepancies to the Engineer or assume responsibility for the fit of new part to old.

Depth of Footings to be extended if found necessary. See Art. 206.11 of Specifications.

Reinforcing Steel covering shall be 3" in footings, except bottom steel which shall be 4" and 2" in all other parts, unless noted.

Concrete in footings, wingwalls, abutments to be Class "B". Concrete in superstructure and railings to be Class "C". Continuous concrete pours shall be required between construction joints as shown in detail plans.

Waterproof backs of abutments, mudwalls, and wingwalls in accordance with Art. 702.22 of the Specifications. Chamfer exposed edges 1" unless noted.

For pay items covering this structure see Estimate of Quantities.

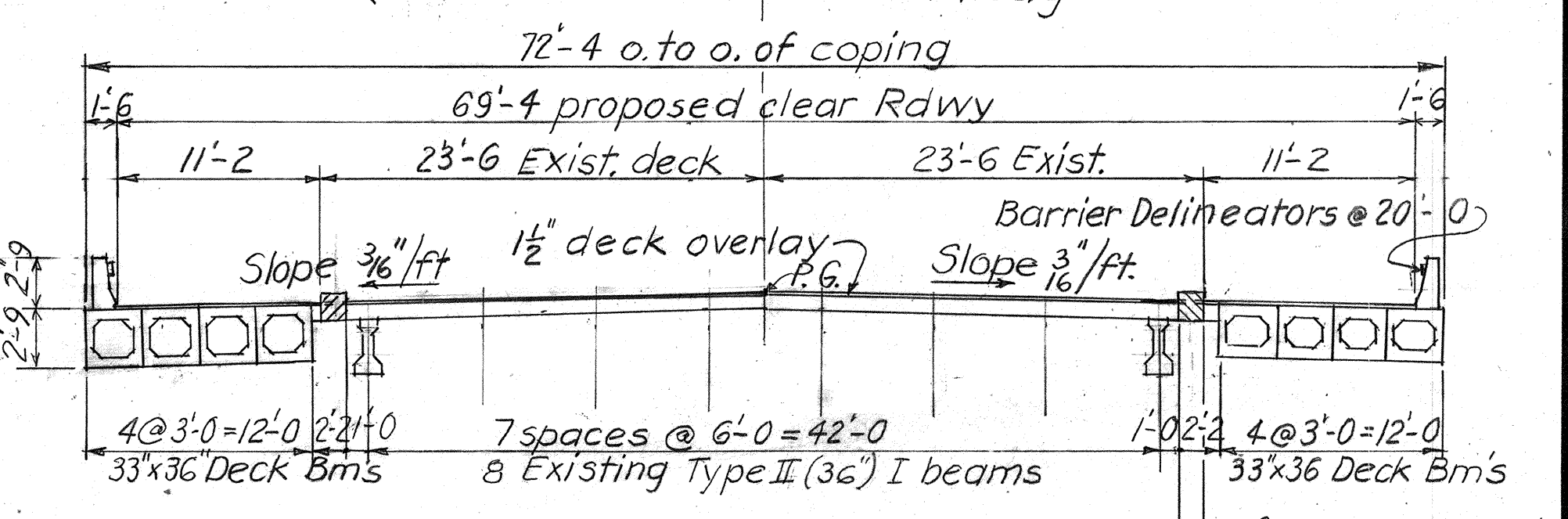
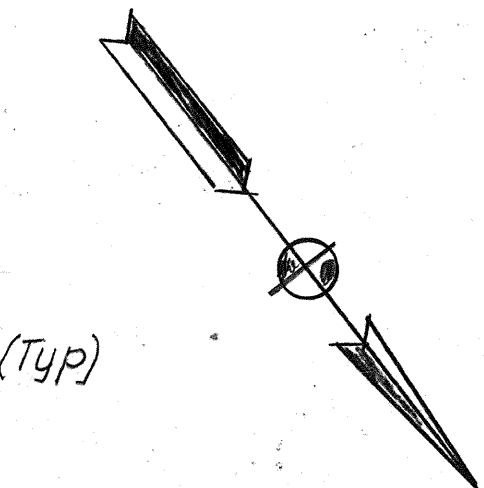
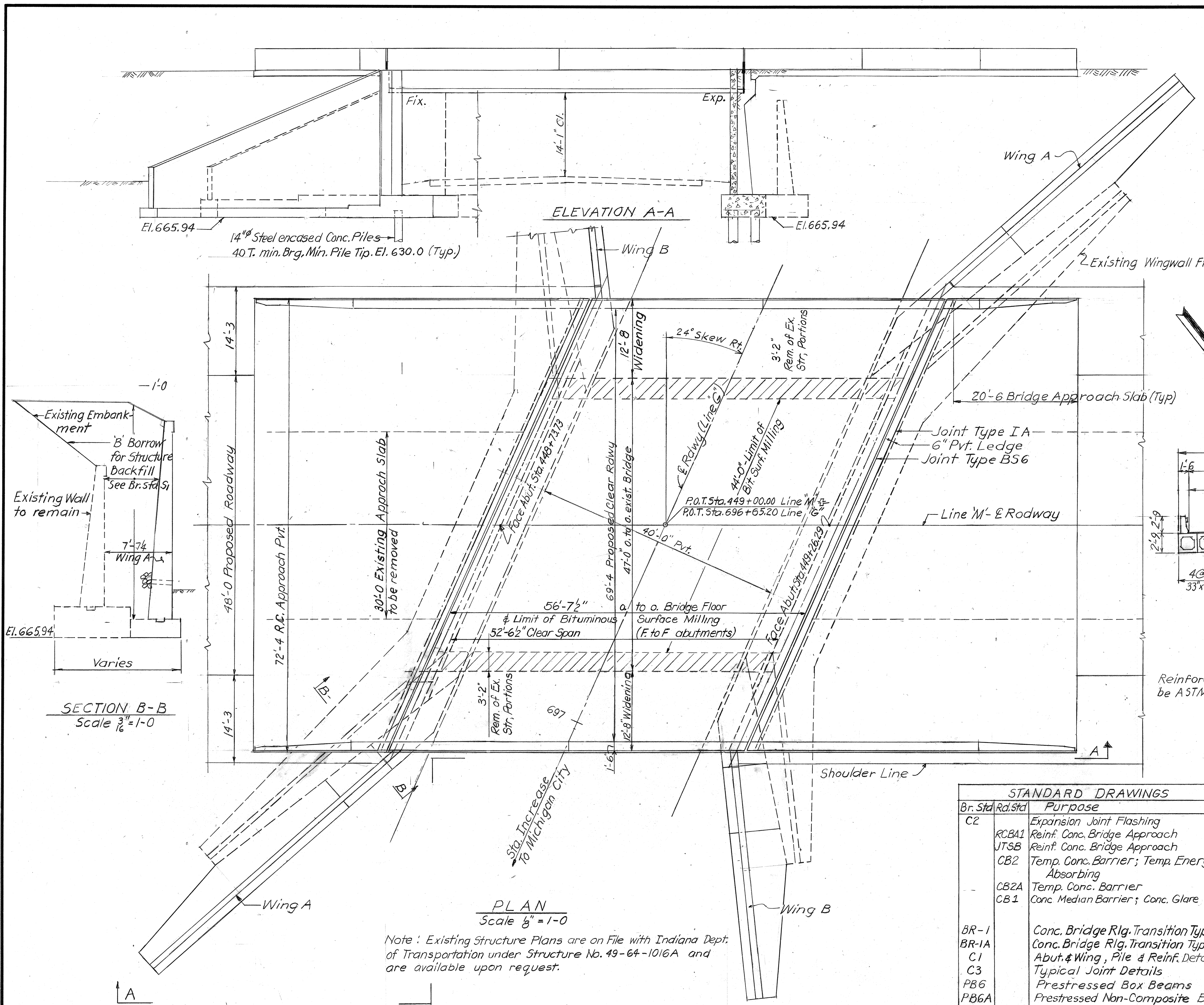

TYPICAL SECTION
Scale 1/8" = 1'-0"

DESIGN DATA
 Reinforcing Steel shall be ASTM A615, Grade 60.
 Deck Beams shall be in accordance with Bridge Std. PB-6A
 Reinforced Concrete Unit Stresses: $f'_c = 24,000$ p.s.i.
 $f'_s = 1,200$ p.s.i.
 Live Load: HS 20-44 in accordance with 1989 AASHTO Specifications.
 Dead Load: Actual weight plus 35 p.s.f. allowance for future wearing surface.

SECTION B-B
Scale 3/8" = 1'-0"

PLAN
Scale 1/8" = 1'-0"

Note: Existing Structure Plans are on file with Indiana Dept. of Transportation under Structure No. 49-64-1016A and are available upon request.

STANDARD DRAWINGS		Purpose
Br. Std.	Rd. Std.	
C2		Expansion Joint Flashing
RCBA1		Reinf. Conc. Bridge Approach
JT5B		Reinf. Conc. Bridge Approach
CB2		Temp. Conc. Barrier; Temp. Energy Absorbing
CB2A		Temp. Conc. Barrier
CB1		Conc. Median Barrier; Conc. Glare Screen
BR-1		Conc. Bridge Rlg. Transition Type T&B
BR-1A		Conc. Bridge Rlg. Transition Type T&B
C1		Abut. & Wing, Pile & Reinf. Details
C3		Typical Joint Details
PB6		Prestressed Box Beams
PB6A		Prestressed Non-Composite Box Bms
S-1		'B' Borrow Placement
PB-10		Tolerances for Fabrication of Prest. Beams

GENERAL PLAN
 WIDENING OF EXISTING PRESTR. CONC. I-BM. BRIDGE
 Single Span @ 52'-6 1/2" (clear)
 Skew 24° Right
 47'-0" Clear Roadway widened to 69'-4"
 SR 49 over US 20

INDIANA DEPARTMENT OF TRANSPORTATION

SCALE: - As noted DATE: - 1993

DRAWING: - 52 OF 8 SHEET: - 6 OF 44
 PROJECT: - NH-089-4() STATION: - 449+00
 BRIDGE CONTRACT NO. R-22220
 BRIDGE FILE: - 49-64-1016B

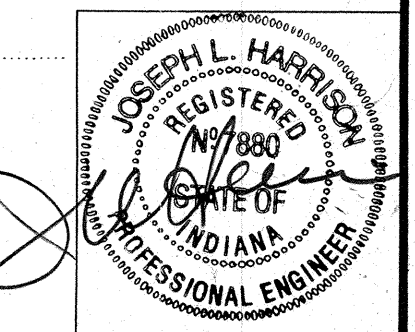

DESIGNED: HMC CKD: A.P.
 DRAWN: HMC CKD: A.P.
 TRACED: CKD

SF-22317

Slope of wall = $\frac{1}{470} = 0.0021$

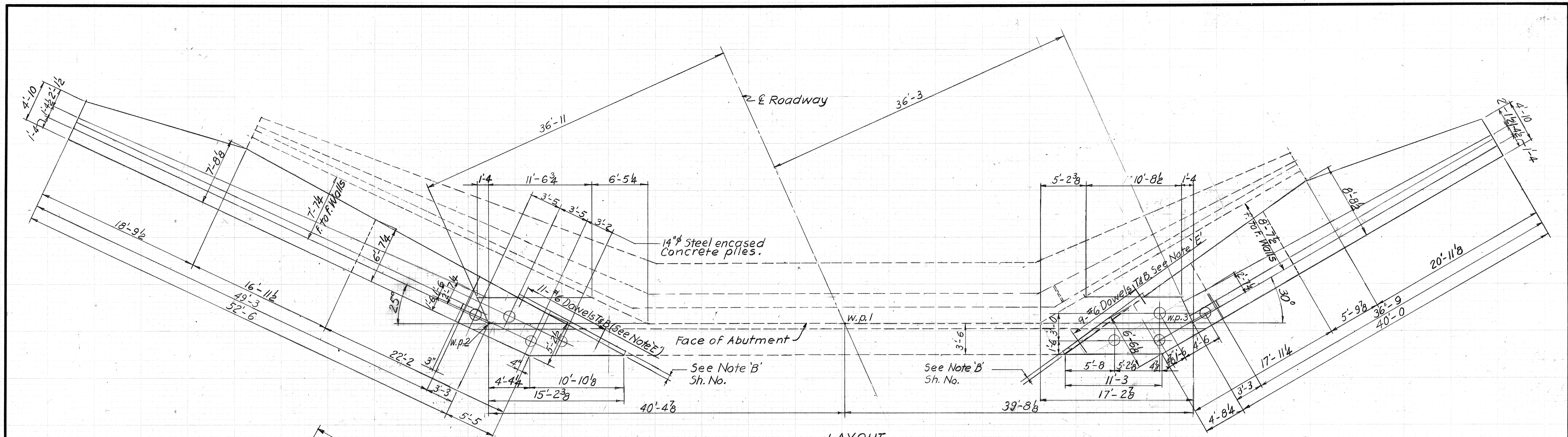

LAYOUT
Scale: $\frac{3}{16} = 1'-0$

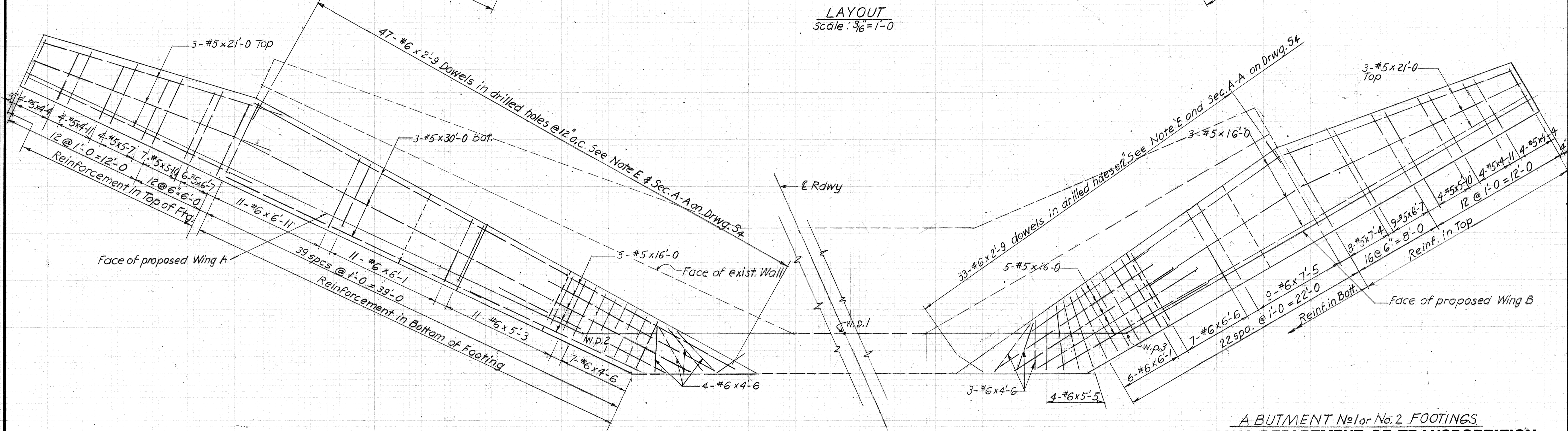

FOOTING REINFORCEMENT
Scale: $\frac{1}{4} = 1'-0$

A BUTMENT No. 1 or No. 2 FOOTINGS
INDIANA DEPARTMENT OF TRANSPORTATION

SCALE: - As noted

DATE: -

19

DESIGNED: *HW* C.K'D. *A.P.*
DRAWN: *HW* C.K'D. *A.P.*
TRACED: C.K'D.
SF-22317

DRAWING: S3 OF 8 SHEET: 7 OF 44
PROJECT: NH-089-4() STATION: -449+00
BRIDGE CONTRACT NO. R-22229
BRIDGE FILE: 49-64-1016 B

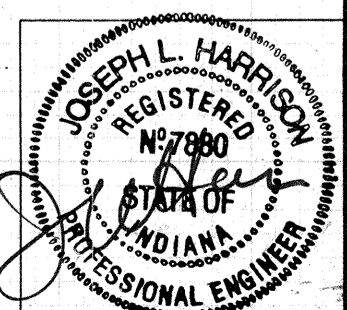

Note 'A': See Section for Location and spacing of Bars.

Note 'B': Undercut 1" minimum behind reinforcement bars. 3" minimum of concrete removal.

Note 'C': Clean and straighten bars and incorporate in new construction.

Note 'D': Remove hatched portions of mudwalls to the bridge seat level. Remove cross hatched areas to El. M = 682.64 ±

This portion of Mudwall to be poured after deck beams are in place

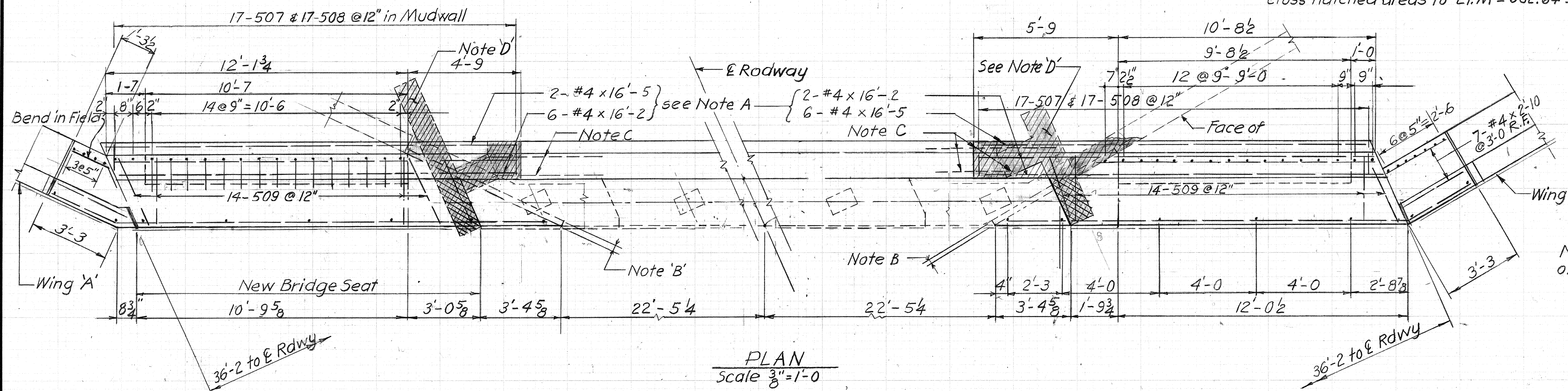

SECTION C-C

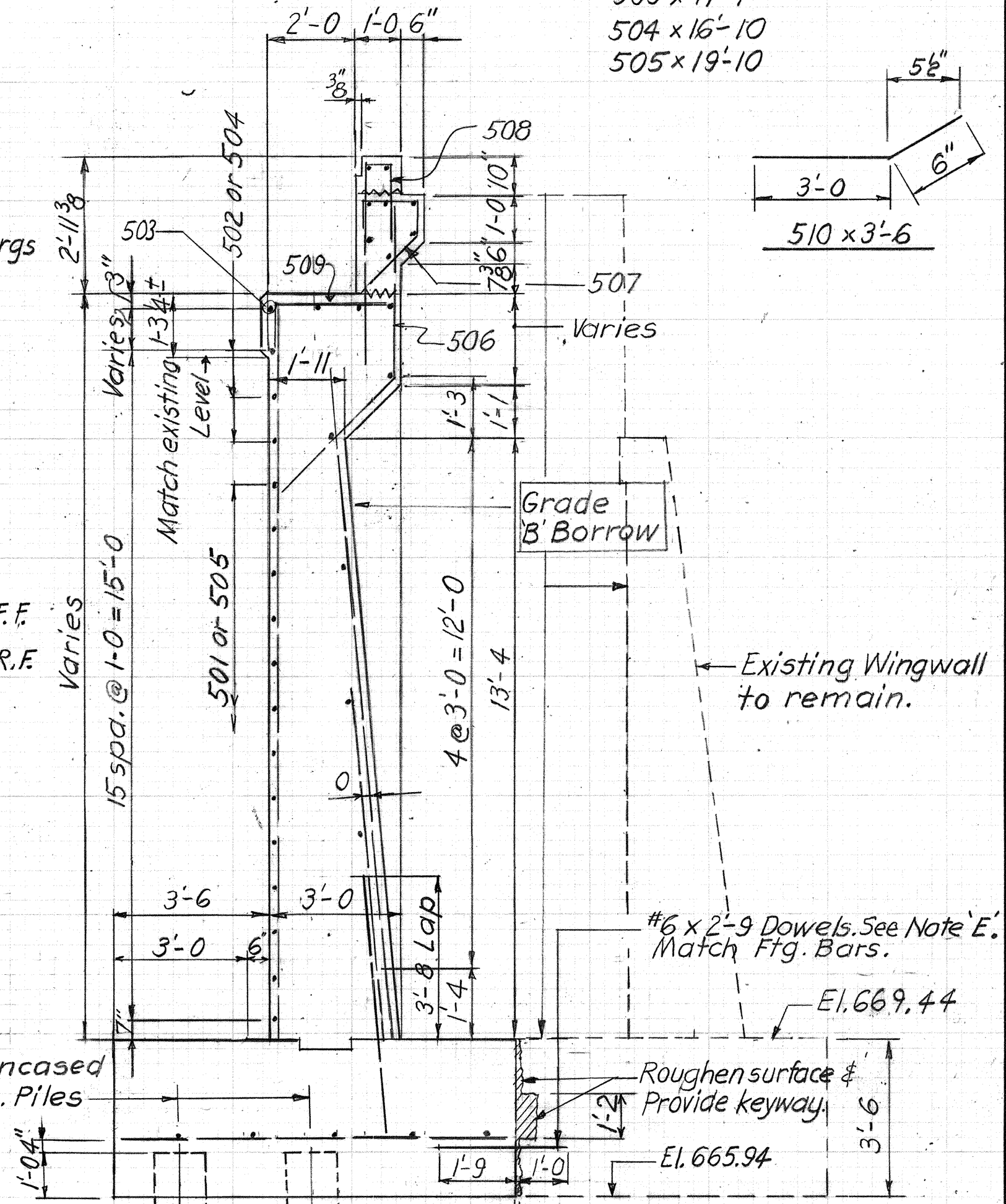
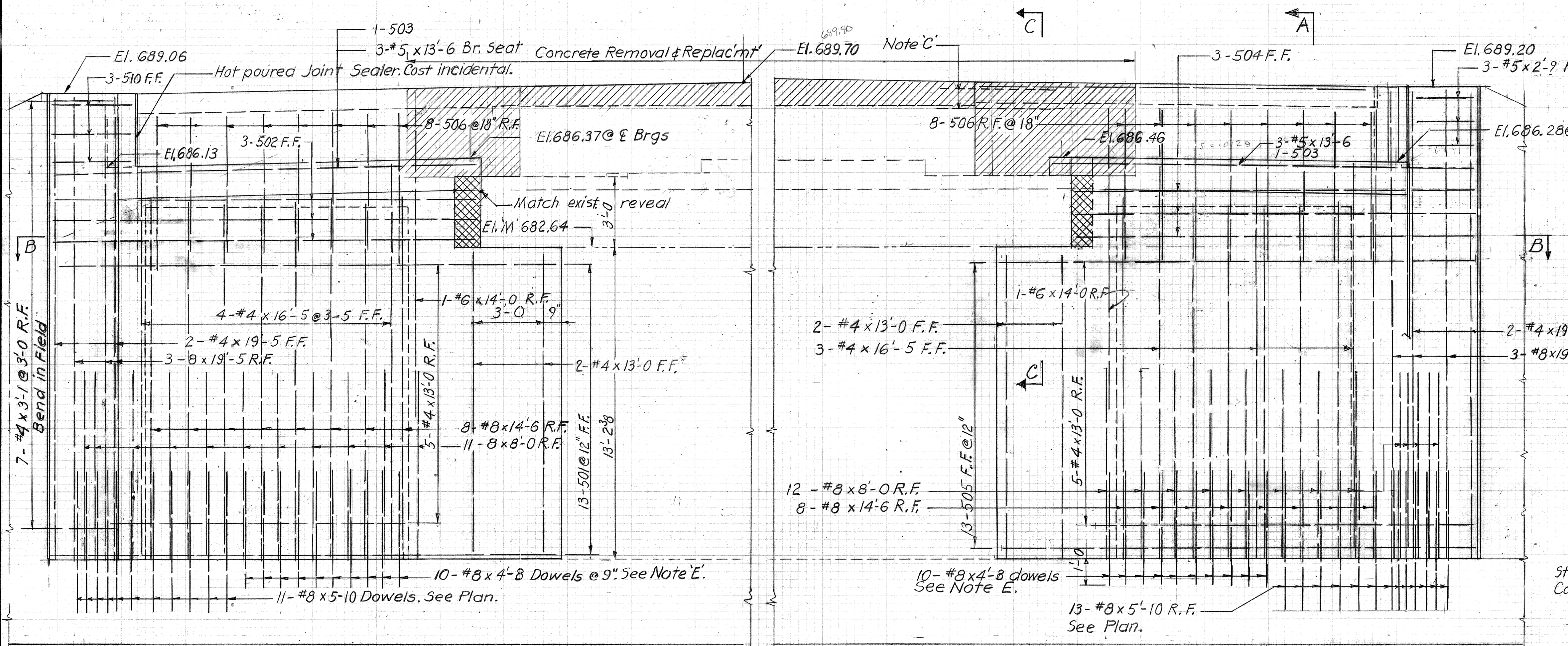
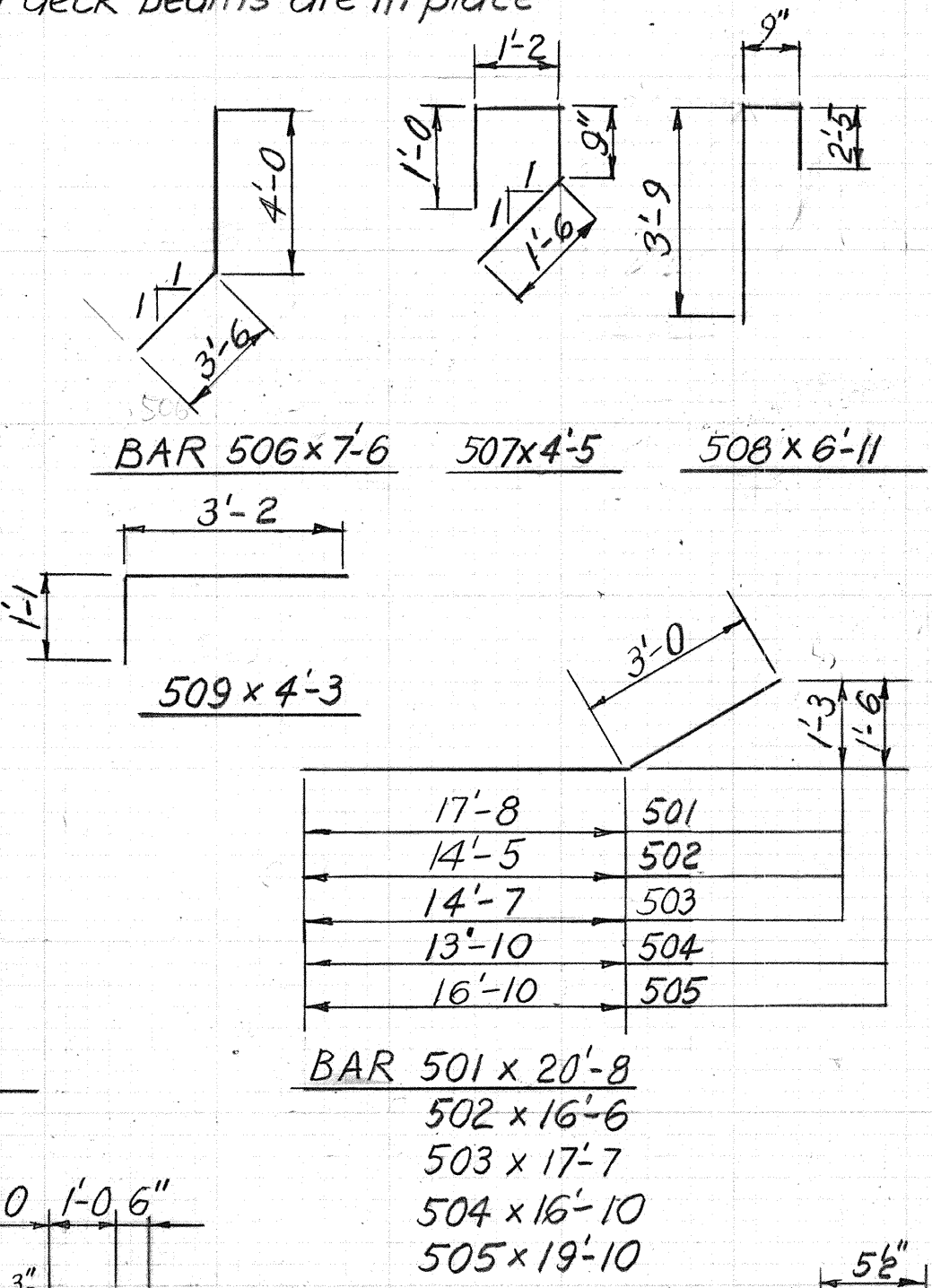

INDIANA DEPARTMENT OF TRANSPORTATION
ABUTMENT No.1 or No.2 STEMS

SCALE: 3/8"=1'-0" DATE: SENIOR DESIGNER

DRAWING: S4 OF 8 SHEET: 8 OF 44
PROJECT: NH-089-4() STATION: 449+00
BRIDGE CONTRACT NO. R22229
BRIDGE FILE: 49-64-1016 B

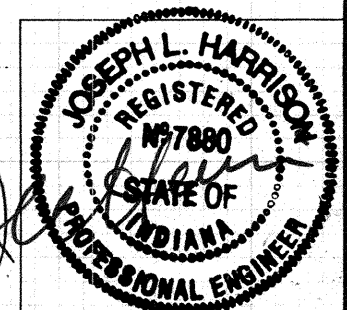

DESIGNED: [Signature] C.K.D. A.P.
DRAWN: [Signature] C.K.D. A.P.
TRACED: C.K.D.

SF-22317

Note 'E': Field drill holes in existing Ftg. for dowels. Use approved anchor system. Min. Pullout 46,500 Lbs. for #8 bars and 26,400 Lbs for #6 horiz. dowels.

* Note: Dowel rods to be grouted and allowed to cure prior to grouting shear keys.

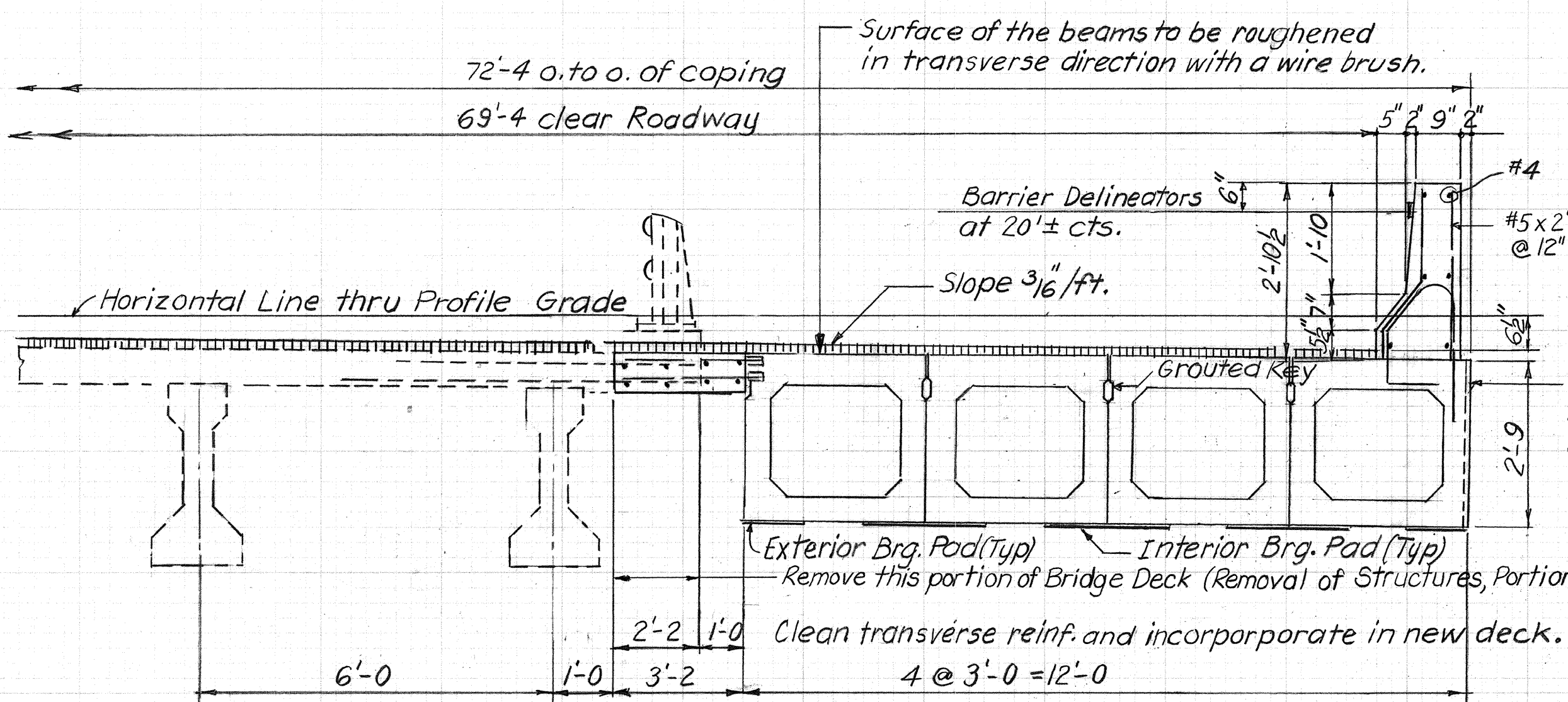

PART CROSS SECTION
Scale: 1/2" = 1'-0"

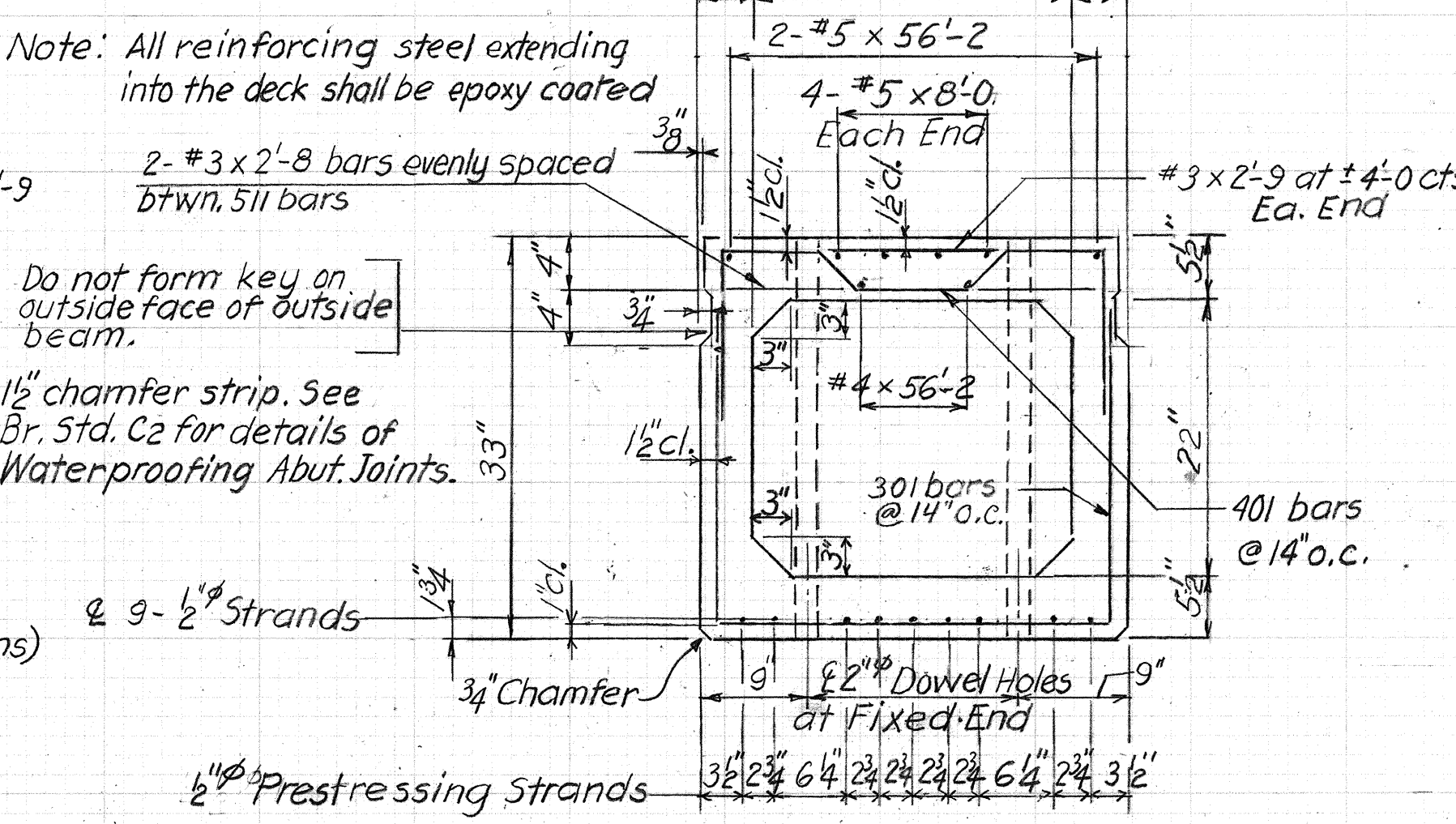

TYPICAL BEAM SECTION
Scale: none

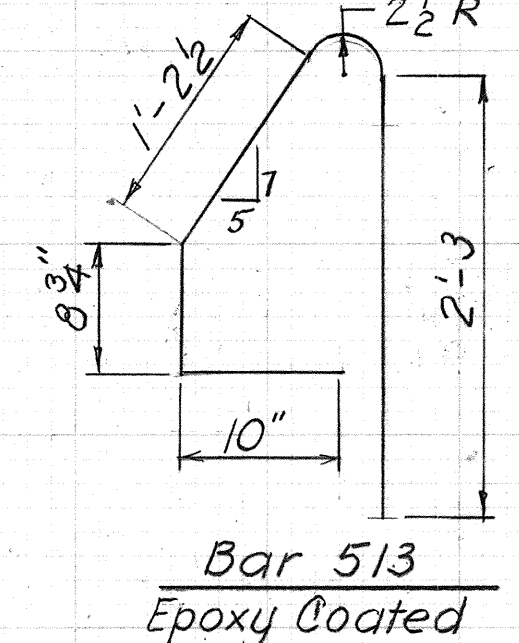
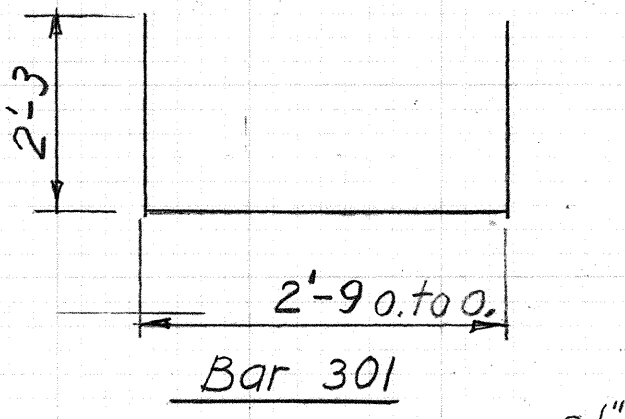
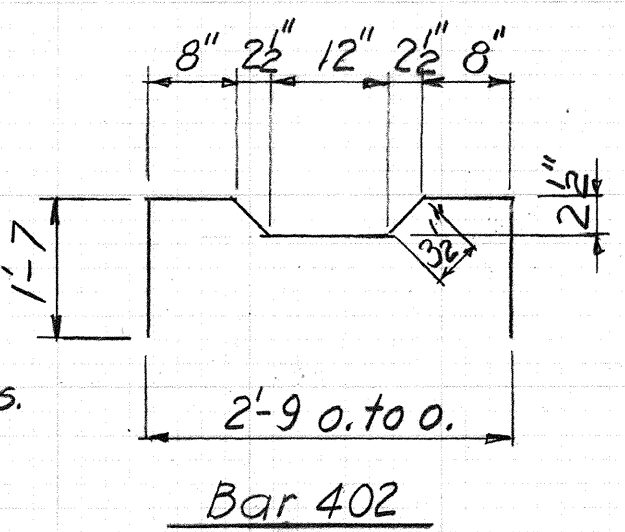

BAR 401

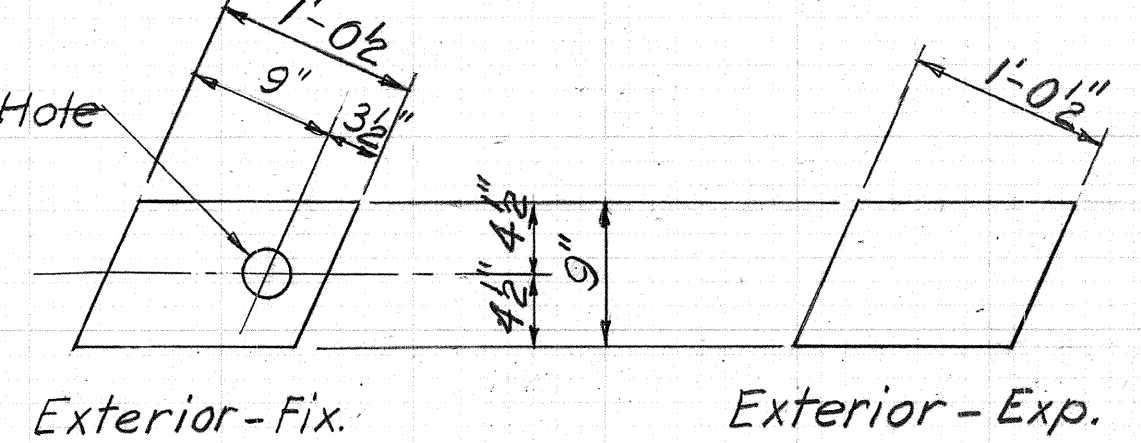
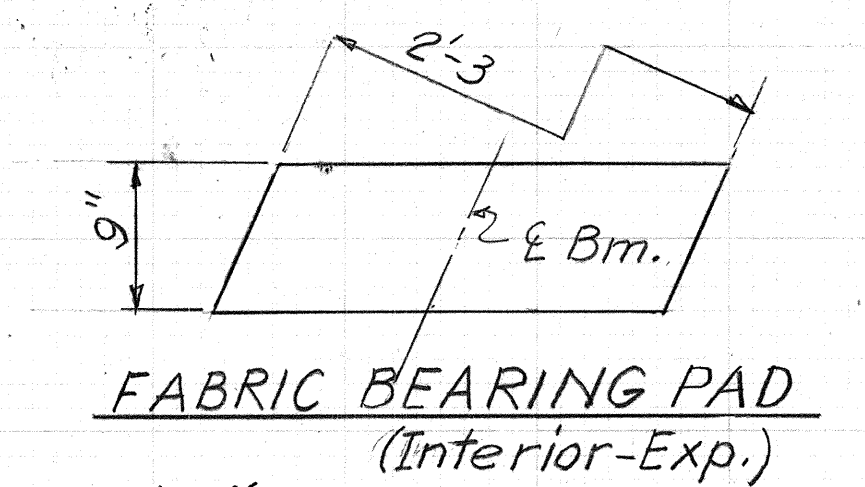
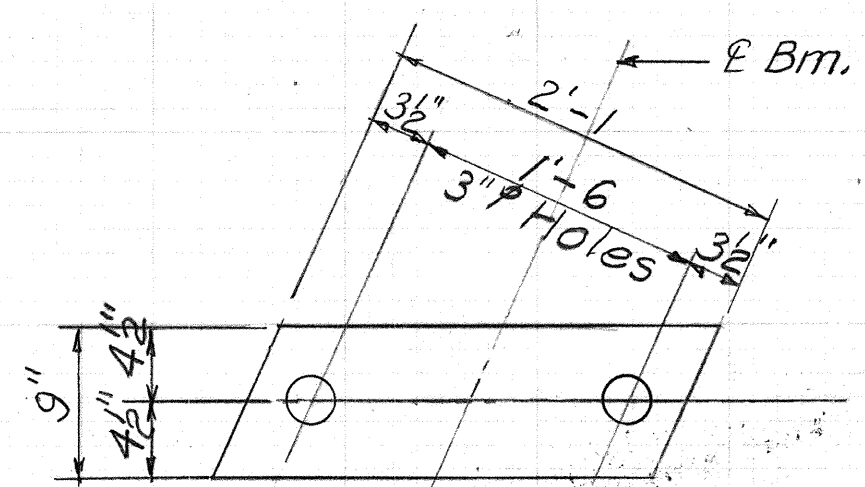

Note: The bearing seat surfaces shall be adjusted by shimming to ensure firm and even bearing. Two 1/2" fabric adjusting shims of the dimensions of the exterior bearing pad shall be provided for each bearing.

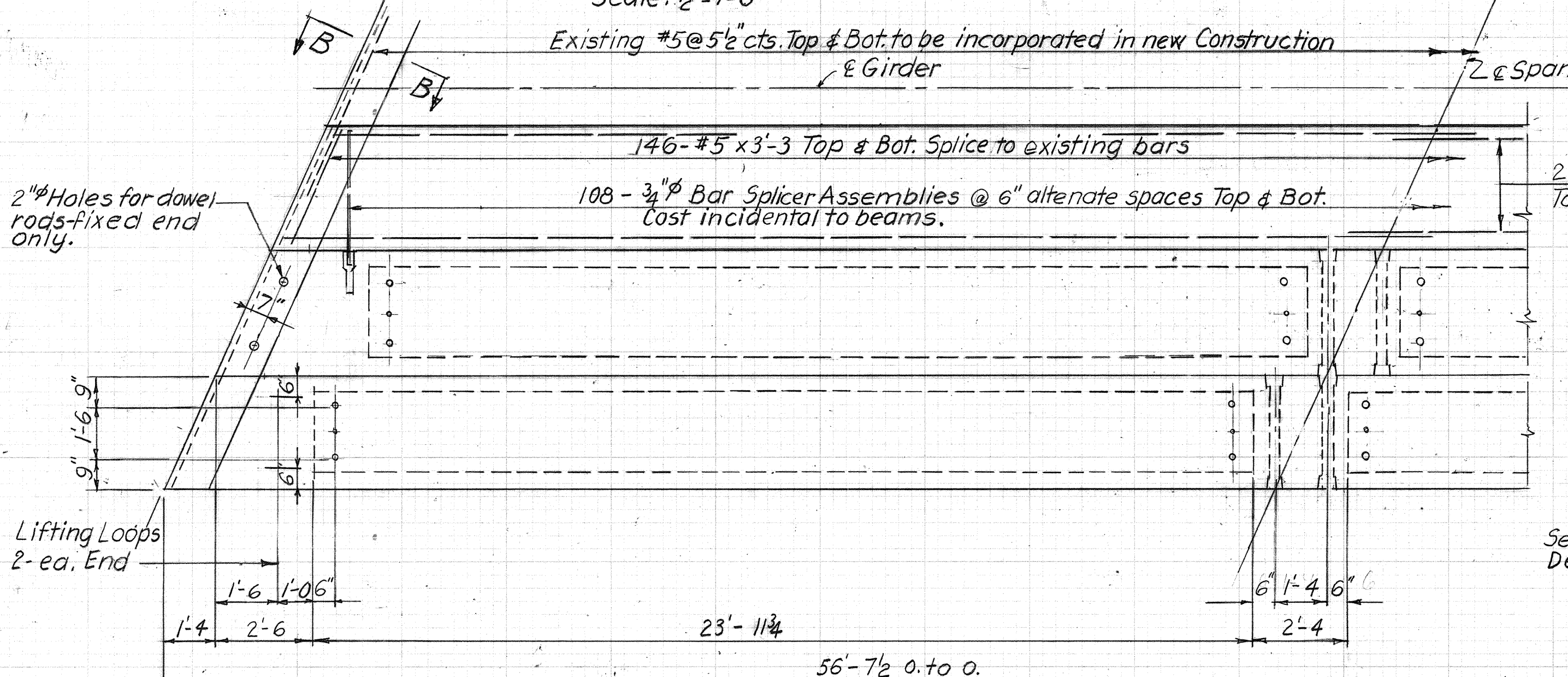

PART PLAN
Scale: 3/8" = 1'-0"

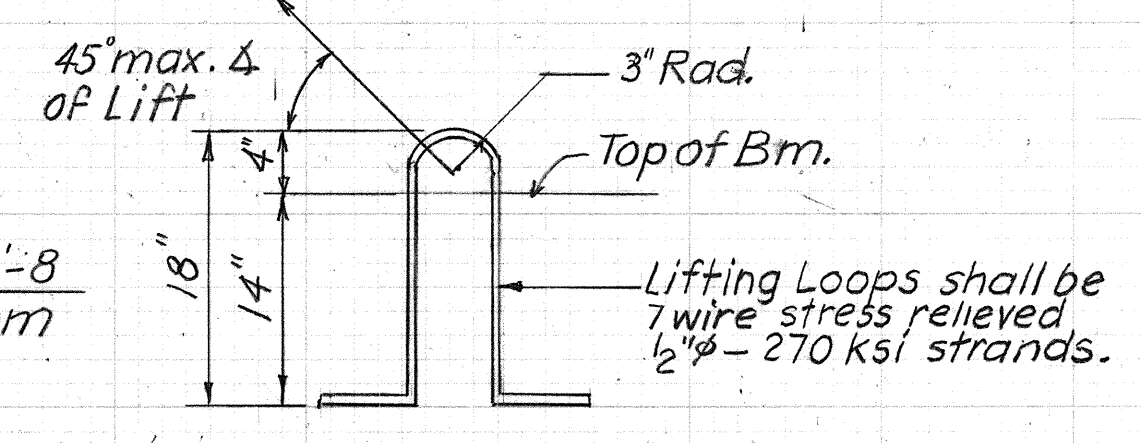

LIFTING LOOP DETAIL

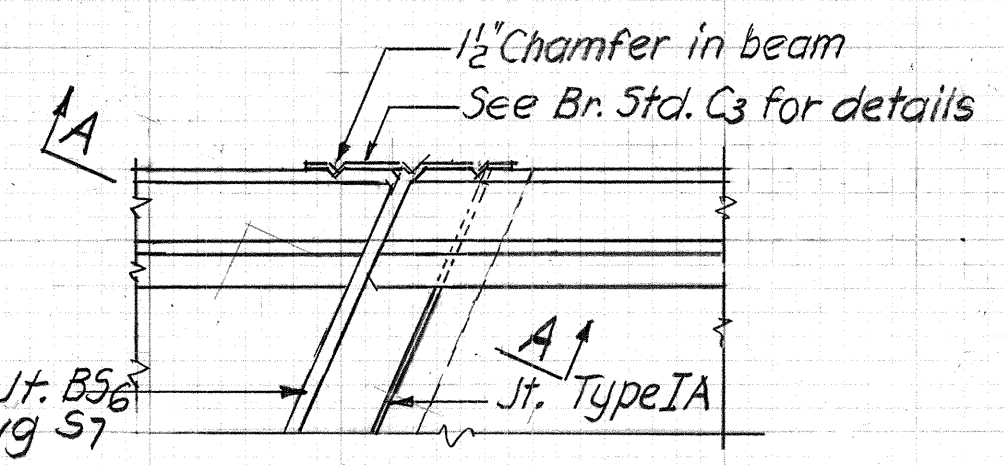

PLAN

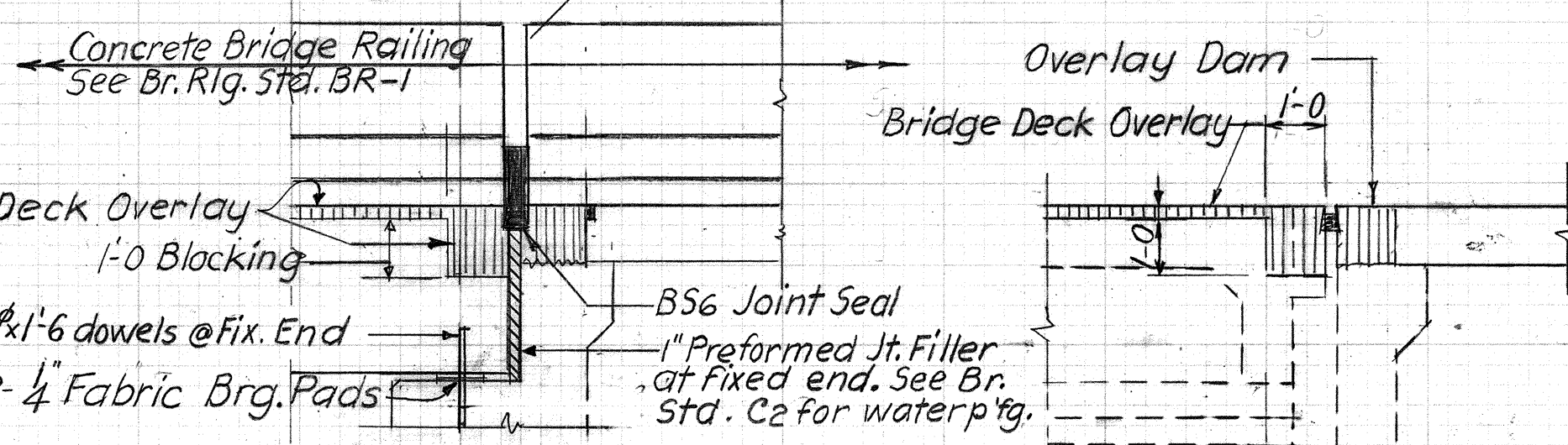

SECTION A-A

SECTION B-B
Scale: 3/8" = 1'-0"

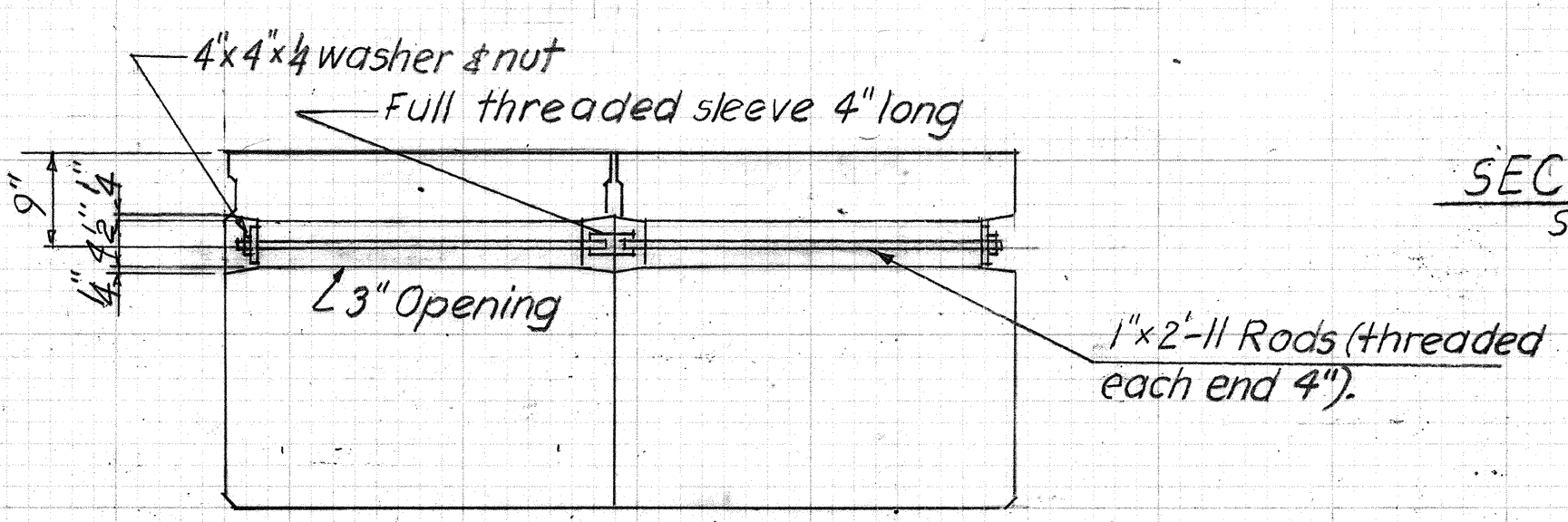

SECTION C-C

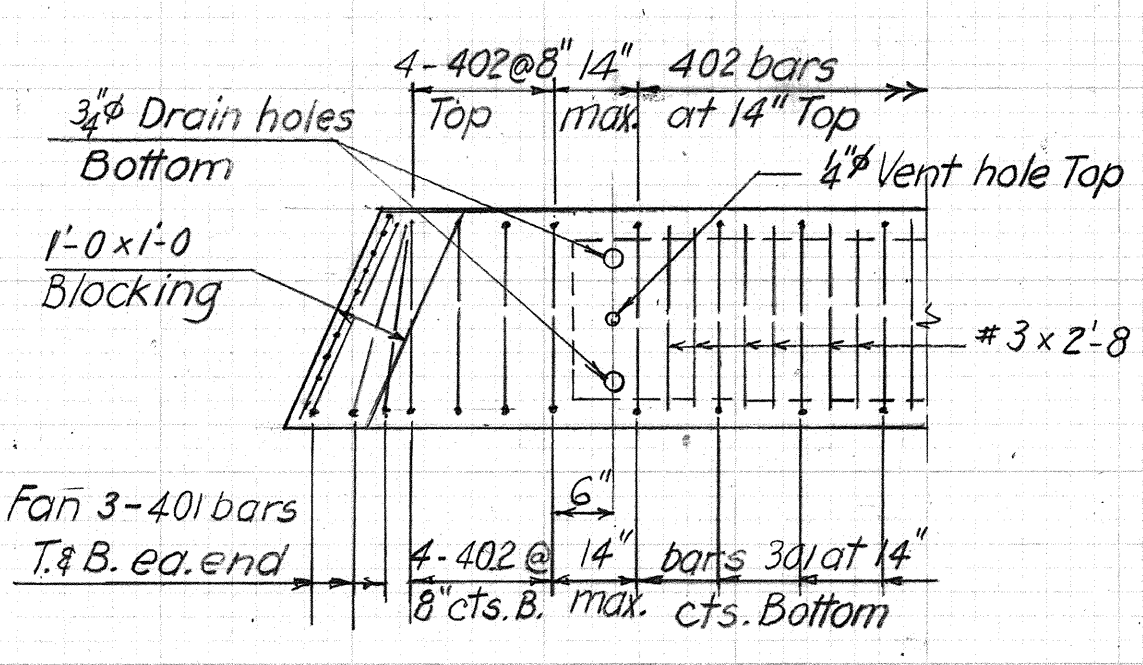

END REINFORCEMENT
Scale: 3/8" = 1'-0"

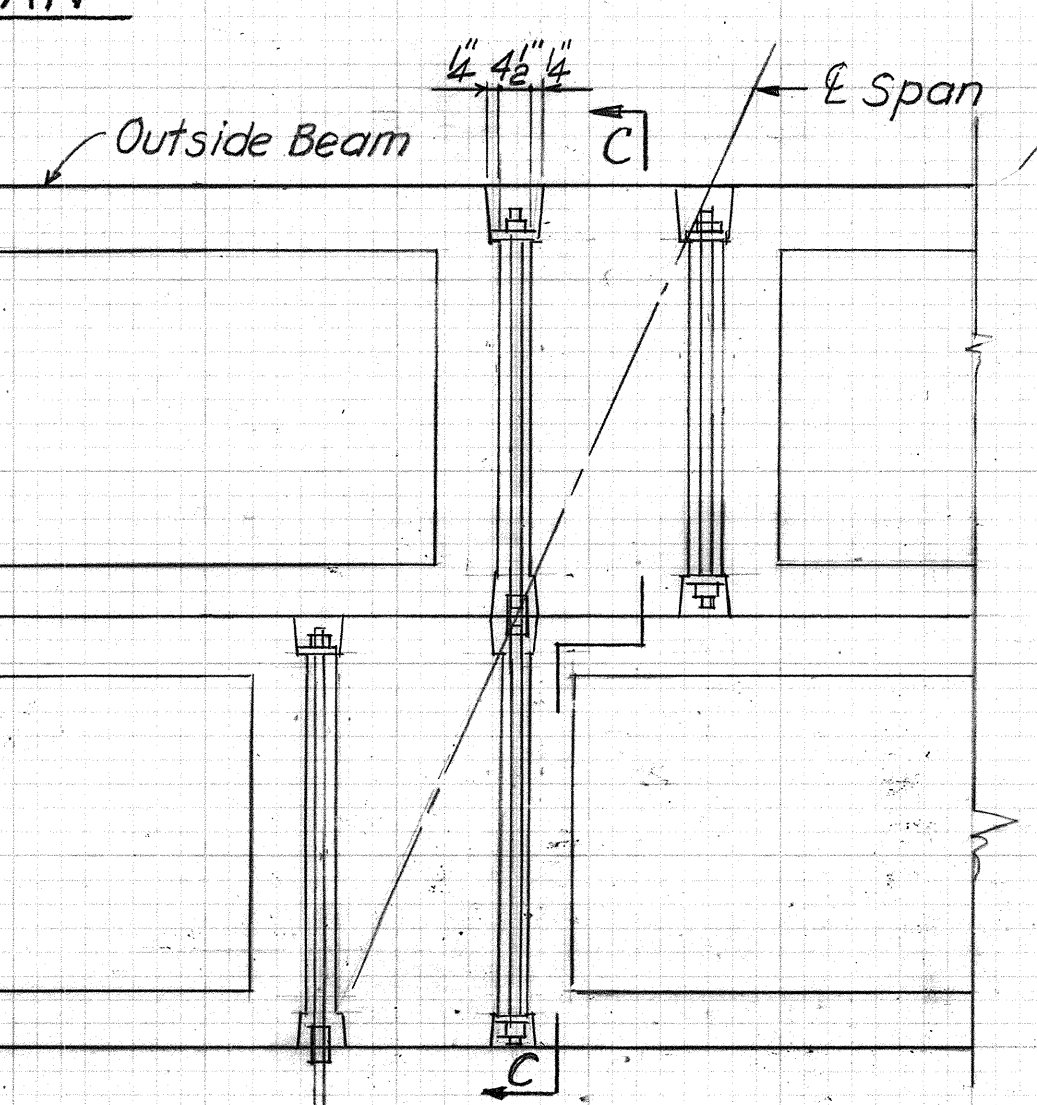

TYPICAL TRANSVERSE TIE ASSEMBLY
Scale: 3/4" = 1'-0"

1. Prestressing steel shall be 1/2" nominal dia. uncoated seven wire special Lo-Lax strands, Grade 270 ksi and 0.167" cross sectional area, conforming to ASTM A-416. The initial force applied to each strand shall be 28,900 Lbs.
2. Reinforcement bars shall conform to AASHTO M-31 or M-33, Grade 60.
3. See Br. Std. C1 for Reinforcing Bar Notes.
4. See Br. Std. P.B6 for General Notes.
5. See Br. Std. P.B10 for Notes & Tolerances.
6. After beams have been erected, drill holes for anchor dowels and fill holes with grout.
7. Cost of reinforcement cast into the beam, of bearing pads and grouting longitudinal shear keys included in the unit price of 33' x 36" beams.

Size & Mark	No. of Bars	Length	Weight
#5	584	3'-3	
#5	16	28'-8	
Total #5 Epoxy Coated			2460#
Total Reinforcing Stl.			2460#
Pour No.1 (West)			4.1 cu. y.
Pour No.2 (East)			4.1 cu. y.
Total Class C Conc. in Bridge Floor			8.2 cu. y.

MISCELLANEOUS	
Concrete Structural Member,	1359 sq. ft.
Prest. 33' x 36" Bms	277 sq. ft.
Surface Milling	240 SFT
Partial Depth Bridge Deck Patching	8.7 CYS
Additional Bridge Deck Overlay	456 SFS
Bridge Deck Overlay	166 LFT
Expansion Joint B56	16 ea.

SUPERSTRUCTURE DETAILS
INDIANA DEPARTMENT OF TRANSPORTATION

SCALE: - As noted

DATE: -

19

DESIGNED: *WJ* C.K.D. A.P.
DRAWN: *WJ* C.K.D. A.P.
TRACED: C.K.D.

PROJECT: NH-089-4() STATION: -449+00
BRIDGE CONTRACT NO. R-22-29
BRIDGE FILE: 49-64-1016B

